

technagon

charged by innovation

TEW6

→ DC Wallbox
Technagon TEW6



Features & functions

- Charging station with 2 charging points for public and semi-public area
- Max. charging capacity: 60 kW | Configurable by qualified electrician
- KfW eligible
- AFIR and calibration law compliant, controllable according to §14a EnWG
- Plug and Charge (ISO15118)
- Unique, modular concept enables simple handling of handling the issues of service and calibration law
- Ethernet connection (LAN) and 4G mobile connection as standard
- Connection of all leading backend providers via OCPP1.6
- Cable management available
- Service socket included
- LED topper with color and flashing codes for status display
- Powder-coated aluminum housing - complete DB703
- 4.3 inch color display and RFID reader per charging point
- Display of static and dynamic QR code possible
- Intuitive and language-independent user guidance
- Integration of a universal payment terminal (credit card, Girocard, fleet cards, Apple or Google Pay)
- Load management in various levels included
- Simple connection to terminals | cable feed from below
- Mounting on the wall or on the optionally available Technagon stele
- Prefabricated foundation available as an accessory
- Vehicle2X ready

Intelligent & powerful



The DC Wallbox TEW6 with two charging points has a charging capacity of 49 kW. A power reduction to 49 kW is possible in order to bypass the required credit card terminal in the AFIR. The integrated DC charging module is certified as a closed unit under calibration law, which makes operation and servicing much easier.

Highlight

The unique charging module opens up completely new possibilities in charging technology. Certified as a closed component, it makes it easier to comply with calibration law and revolutionizes service.

The DC charging module has a charging current of max. 200 A and can be easily replaced when servicing is required.



- heart of the Technagon P/W series
- unique, innovative design
- certified according to calibration law
- revolutionary service concept
- intuitive user guidance on the display
- symbolic and language-independent

Basic variant



Standard version
Cable length: 3m



With cable management as an option
Cable length: 5.5m



Compliant with calibration law
as standard



charged by innovation

Dimensions (mm)

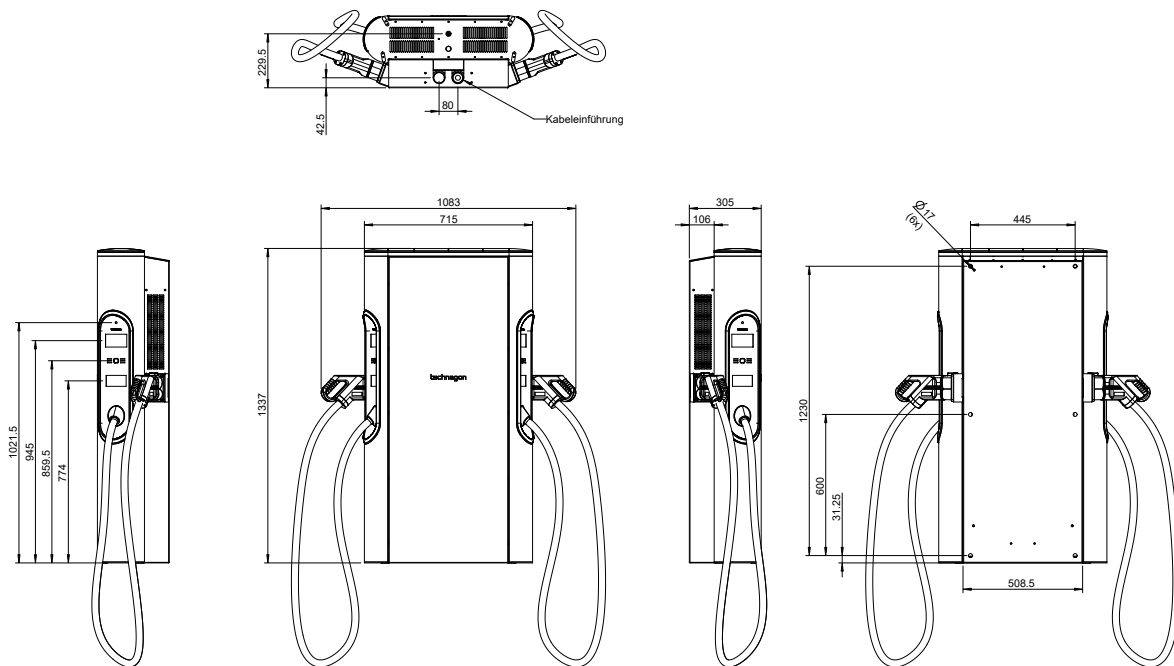

Technical information

Performance features and functions

Authentication	via RFID cards (ISO 14443) MIFARE Ultralight, Classic or DESFire; Plug & Charge
Screen	4.3-inch display per charging point to show operator data, prices, QR codes
Charging connections	2x IEC 62196 CCS type 2 charging cable with 3 m length Optional cable management with 5.5 m cable

Mechanical design

Dimension	1350 x 715 x 340 mm (H x W x D)
Weight	depending on version 130 - 150 kg
Operating temperature range	-25 °C bis +50 °C
Installation site	≤ 2.000 m (altitude above sea level)
Relative humidity	5 to 95%, non-condensing
Protection class	IP54
Vandalism protection	IK10
Mounting type	Wall mounting with mounting kit Floor mounting with stele
Mechanical enviromental conditions	M2

Technical information

Electrical version

Grid connection	Mains connection: 3P+N+PE, max. 5 x 50 mm ² copper, Rated voltage: 230/400 VAC 50 Hz, rated current: 90 A, Back-up fuse: max. 125 A - RCD required on site
Security	Fuses per charging point AC: 3 x 80 A NH Fuses per charging point DC: 125 A NH Insulation monitoring; temperature derating; FI-LS 10 A for control voltage Door contact; optional emergency stop switch
Lightning and overvoltage protection	Optional combination arrester Cat. I+II+III AC according to DIN EN 61643-11 optional combination arrester Cat. I+II DC per charging point DIN EN 61643-31 Optional combination arrester for data line in accordance with DIN EN 61643-21
Load management	Static and dynamic load management included (local, Modbus TCP)
Charging connection	150 - 1000V / max. 200 A (1 x 49 kW or 2 x 30 kW)
Status display	LED status display integrated in topper element (remote visibility) Fault detection through different flashing codes
Calibration law	Conformity with calibration law as standard
Energy meter	DIN rail meter compliant with calibration law
Standby consumption	approx. 90 watts
Electromagnetic environmental conditions	E1

Connectivity

Monitoring	Monitoring and diagnostics via OCPP1.6 (OCPP2.1 in preparation)
Remote maintenance	Extensive remote maintenance options via OCPP
Update options	Web interface, Backend
WebInterface	The Technagon web interface can be used to configure the most important parameters that are required for individual operation.
External IT systems	Standard Ethernet and mobile phone connection (max. 4G)

Billing and customer management

Billing	by means of signed, calibration-compliant data records via OCPP
Long-term storage in compliance with calibration law	Local and physically accessible storage of charging data for 8 years via SD card
Customer management	via OCPP or local whitelist (csv import)

Standards

Charging processes	IEC 61851-1, IEC 61851-23, IEC 61851-24 (Mode 4)
Security	IP 54 to IEC 60529, protection class 1 to DIN EN 61140, CE "Class A" to EU Directive 2004/108/EC, DIN EN 55022, IEC 61851-21-2
Calibration law	REA document 6-A, PTB requirement 50.7

Technical information

Shared backend providers

be.energised, Chargepoint, ChargeCloud, evway, Smartlab, Lichtblick, eRound, reev, Vaylens, Monta, MSU, E-Flux and more.

Shared payment providers

GLS, EV-Pay, Hectronic and more.

Shared load management providers

TQ, TMH, Smart1, Wago, IO-Dynamics and more.

Subject to technical changes

Basic version

Article no.	Description
40069.510	DC Wallbox TEW6; compliant with calibration law; 2 charging points

Options and accessories

Article no.	Description
40069.549	Power reduction to 49 kW (credit card terminal not required according to AFIR)
40069.550	Cable management incl. 5.5 m cable length
40069.153	Backend pre-configuration
40069.157	Overvoltage arrester DEHNpatch (Ethernet connection)
40069.544	Overvoltage combined arrester Cat I+II in the DC range per charging point
40069.545	Overvoltage combined arrester Cat I+II+III in the AC range
40069.468	Mobile communications configuration package
40069.547	Credit card terminal in the door (mobile phone connection in the terminal by default, additional network cable required for LAN)
40069.546	Emergency stop switch
40069.551	Foiling ex works TEW6 - Full foiling
40069.552	Foiling ex works TEW6 - Partial front foiling
40069.507	Stele one-sided
40069.195	Prefabricated concrete foundation TEW6
40069.568	Foundation anchor TEW6 (with Stele)
40069.296	Charging module cover (temporary cover)

The uniqueness of Technagon

Our products are much more than simple charging stations. They embody intelligence, sustainability and elegance. Discover our entire portfolio at:
technagon.de



Contact

Technagon GmbH
Brunnwiesen 38
D-94481 Grafenau

Phone: +49 / 8555 / 51700-00
Mail: office@technagon.de
Web: www.technagon.de

